



*COSTRUZIONE MACCHINE AGRICOLE di
DODALDO & C SNC*

Via Sante Salmaso 18/20 46010 BUSCOLDO (MN) ITALY

Tel. +39 0376/410043 - Fax. +39 0376/410032

<http://www.doda.com> Email: doda@doda.com

USE AND MAINTENANCE MANUAL

Hose reeler



All data, pictures and performances mentioned in this manual are only approximate.

The manufacturer reserves the right to make changes without prior notice.

DODA thanks you for having bought an item of its production range and invites you to read this manual.

In it you find all necessary information for the correct use of the machine bought.

Therefore we recommend you to read it wholly and to follow all instructions contained in it.

Furthermore please keep it in a suitable place, so that it could remain unaltered.

The content of this manual can be changed without notice or additional obligations, in case necessary changes or improvements to the units already delivered could be necessary.

It is forbidden to copy or translate any part of this manual without previous authorization.

INDICE GENERALE

CHAPTER	DESCRIPTION	PAGE
1.	Introduction	1
2.	Loading and unloading of the machine	2
3.	General instructions	3
4.	Preliminary checks	4
5.	Positioning and Transport	5
6.	Functioning	6
7.	Operating and Safety Rules	9
8.	Maintenance	10
9.	Stickers	11
10.	Technical Data	12
11.	Overall dimensions	13-15
12.	Exploded Views	16-28

EC DECLARATION OF CONFORMITY AS DEFINED BY DIRECTIVE 2006/42/CE AND FOLLOWING MODIFICATIONS

1. INTRODUCTION

page 1

The equipment described in the following **"USE AND MAINTENANCE"** manual is a reeler for flat hose.

It consists of a galvanised steel bearing frame to be connected with the tractor three point linkage lifting device.

The reel, driven by an hydraulic motor controlled by the tractor distributor, turns on two cast iron holders provided with bearings.

Our reel machine is available with single or multi-stage reel.

From the technological point of view, the concept adopted for all other DODA products has been applied to this machine as well:

" Highest quality for highest reliability and longest service life "

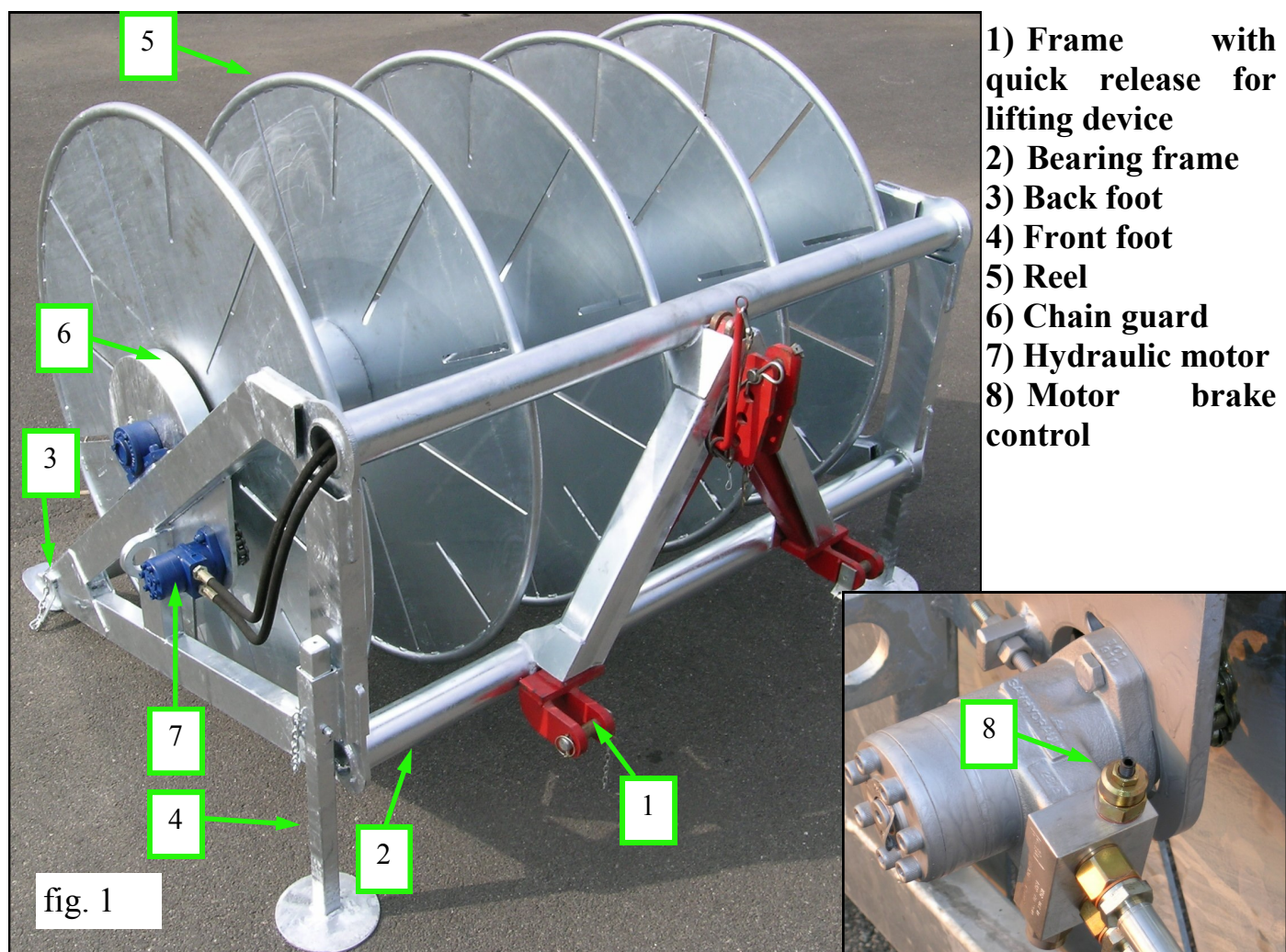

2. LOADING AND UNLOADING OF THE MACHINE

page 2

The machine loading and unloading operation can be carried out by means of:

- a lift truck (fig.2) ;
- a hoisting crane (fig.3).

N.B.: the carrying capacity of the sling must be seven times as much as the machine total weight (if it is made of a textile fibre).

WARNING: in any case the machine can not be lifted by catching on the weakest parts of the structure.

WARNING : before lifting the structure, be sure that it is well-balanced.

WARNING: never move abruptly or bump the reel with the forks of the lift truck.



3. GENERAL INSTRUCTIONS

page 3

- 1) Check that no component has been damaged during transport, in this case contact immediately our dealer .
- 2) DODA takes no responsibility for modifications which could alter the characteristics of the machine bought.
- 3) Before operating the machine it is indispensable to read carefully all directions in the **“Use and Maintenance”** manual. Above all, you have to be sure to have completely understood the machine functioning.
- 4) During machine lubricating, prevent the rolled up hose from coming into contact with oil, grease or oil derivatives.
- 5) During both the equipment stillstand , check if the reeler stands on all feet.
- 6) Protect the equipment against bad weather and UV rays so that rubber and plastic part could wear well.
- 7) Do not park the machine on a sloping surface.
- 8) Do not stop near the machine working area.
- 9) It is recommended that all parts which come into contact with slurry should be washed at the end of each employment.

4. PRELIMINARY CHECKS

page 4

Our machines are usually supplied ready for use, however before setting it in motion we suggest that you should check all parts which need lubricating,

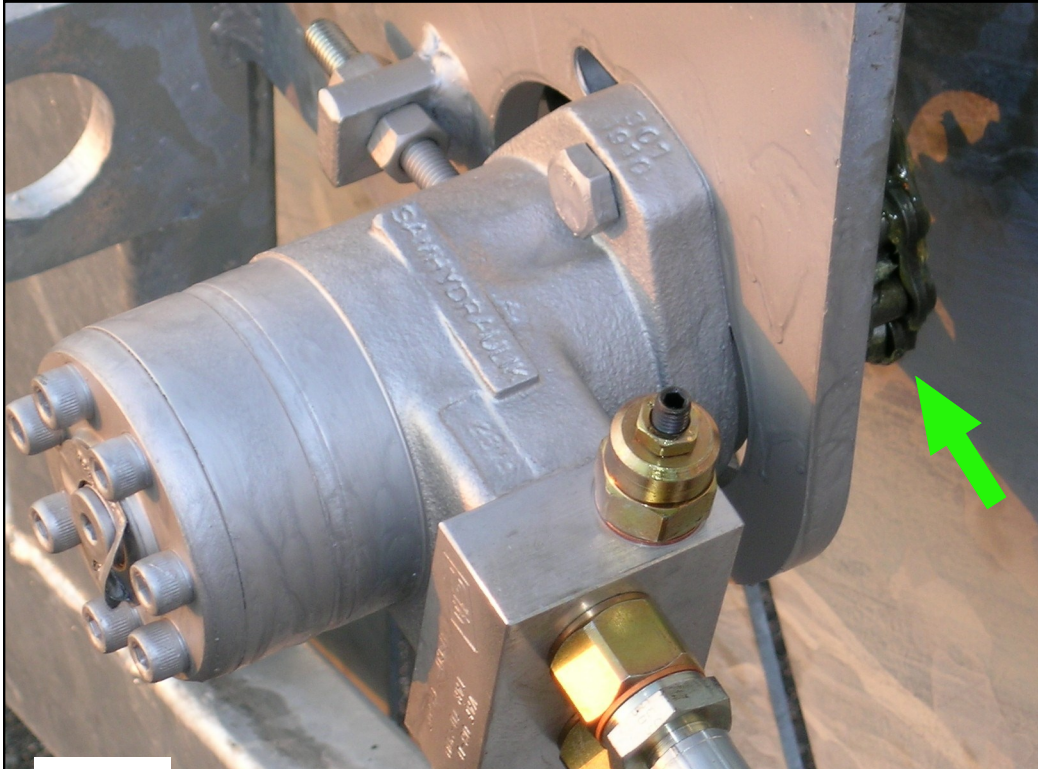

fig. 4

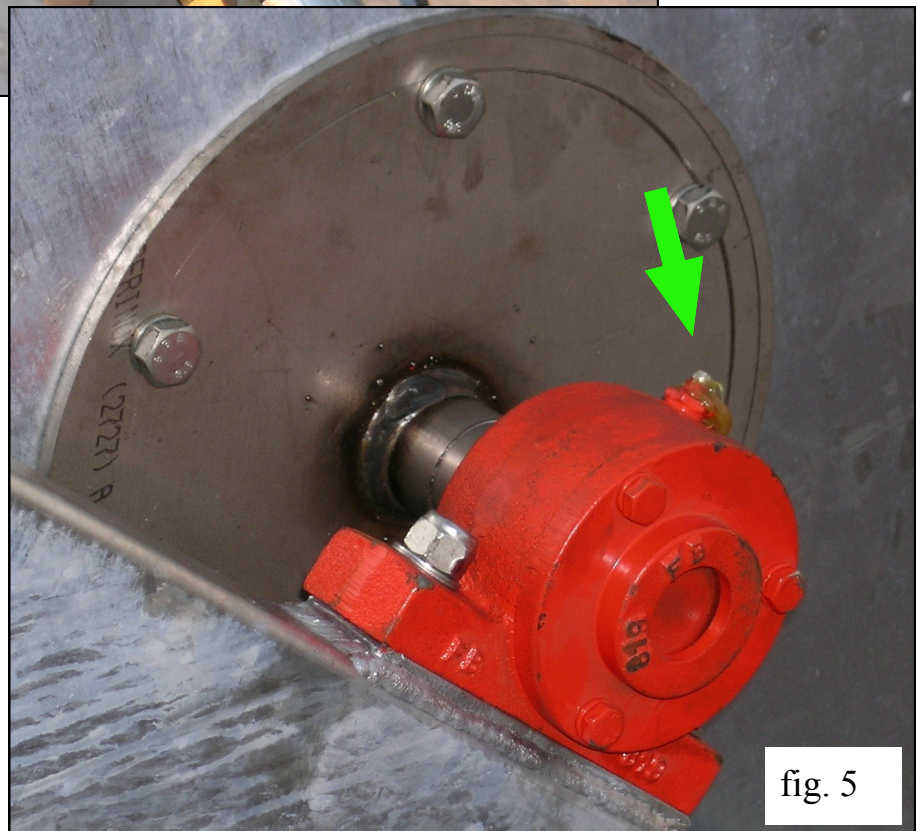

fig. 5

5. POSITIONING AND TRANSPORT

page 5

N.B.: The machine is designed to be lifted up and dragged by a tractor through the 3 point linkage lifting device. ATTENTION: use only hooks of the category 2 or 3.

N.B.: In case of long distance transport of the machine, load it on an suitable vehicle by following the instructions indicated at paragraph “LOADING AND UNLOADING OF THE MACHINE”. Never use a tractor for the machine road transport.

For the connection of the drag injector to the tractor, follow the below -mentioned :

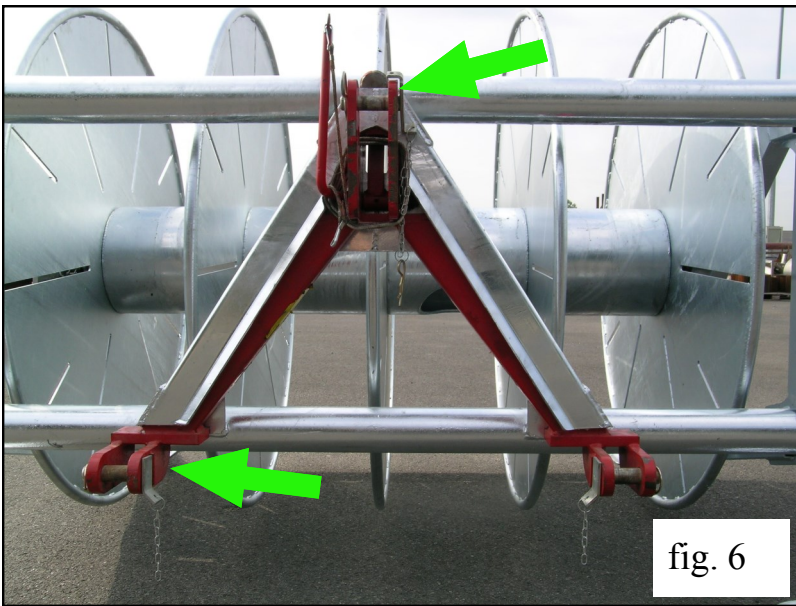

Couple the machine frame to the tractor lifting device through fitting hooks (fig. 6).

Raise as high as possible the bearing feet. (fig. 7-8).

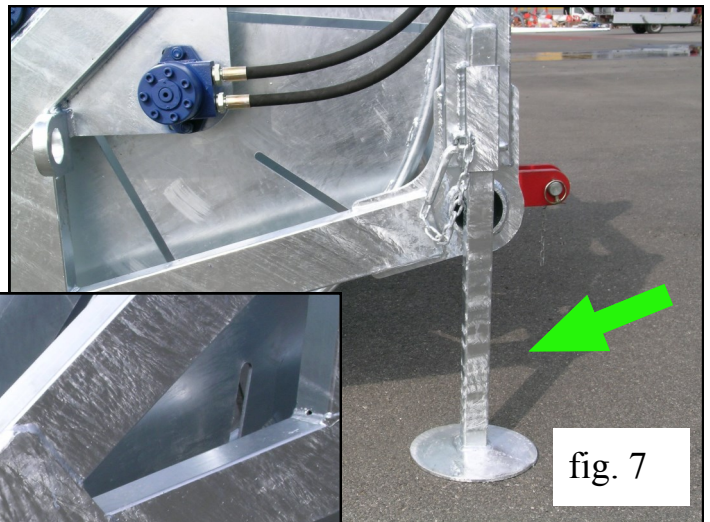

Connect the hydraulic hose of the hydraulic motor to the tractor distributor (fig. 9).

N.B. the hydraulic motor is equipped with an oil flow rate regulator.

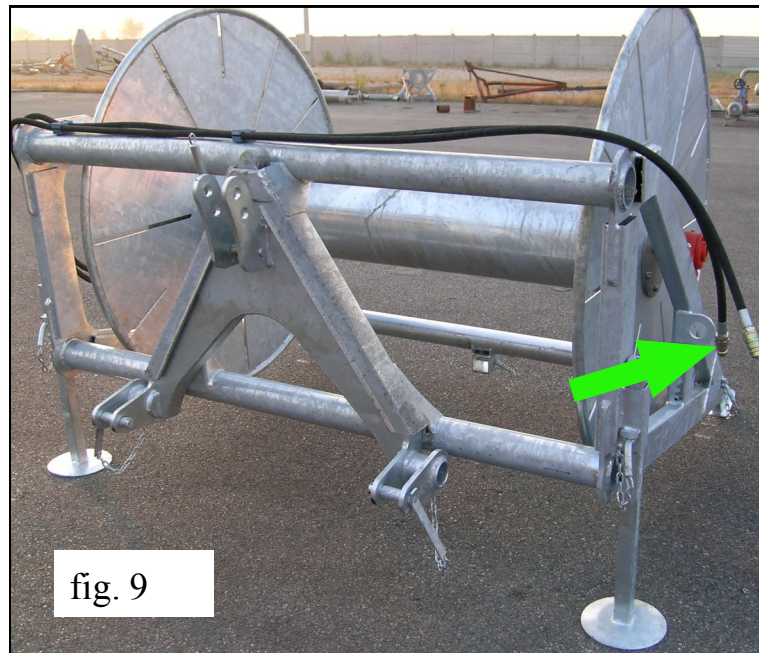

fig. 9

6. FUNCTIONING

This reeler unrolls and rolls up flat hose hydraulically (fig.10).

WARNING:

BEFORE INVERTING THE DRUM ROTATION, WAIT AT LEAST 2 SECONDS AFTER THE DRUM HAS STOPPED.

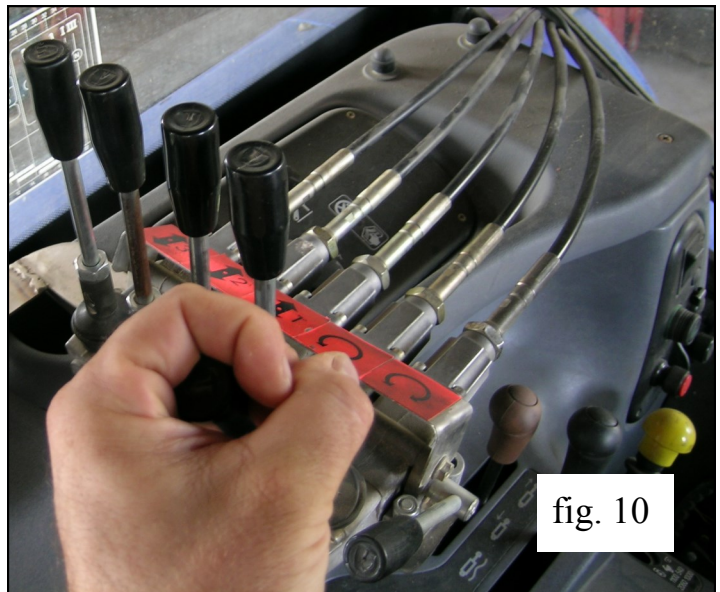

fig. 10

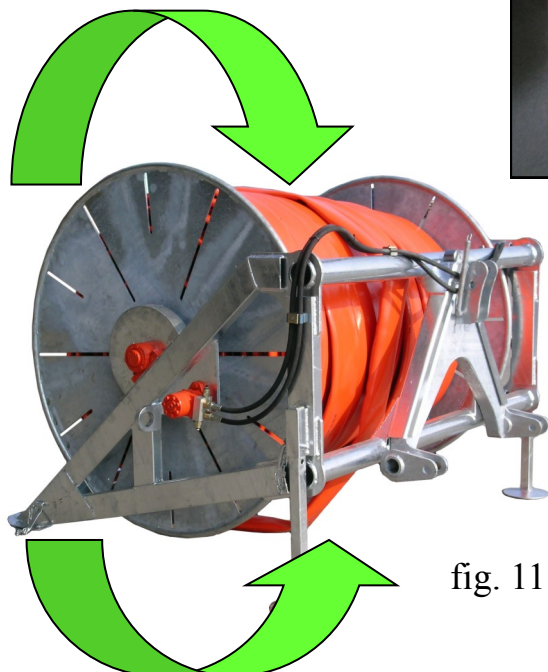

fig. 11

- Drive the tractor where the hose has to be positioned (near the pump or at the output of the slurry transfer piping).
- Keep the releer lifted 30 cm over the ground.
- By the lever, see figure 10, change the reel rotation speed.
- Drive the tractor at a suitable speed.

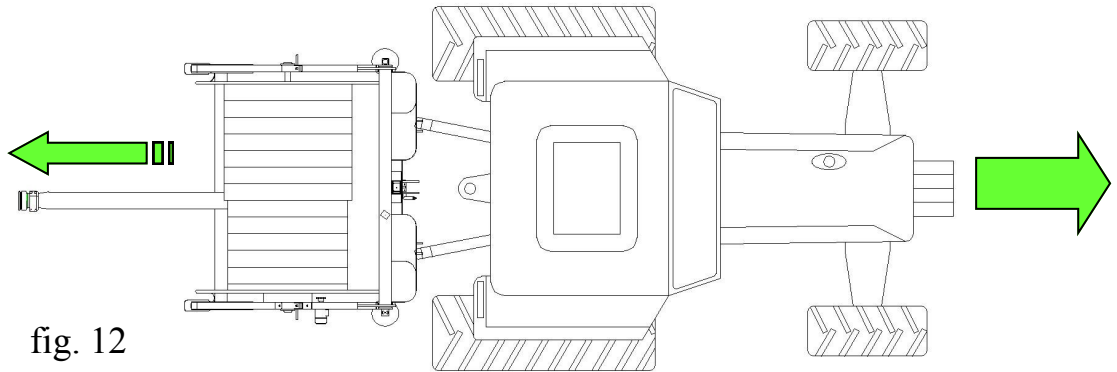

fig. 12

- **Unroll the whole hose** on the ground without putting one segment on another and trampling on it, by leaving at the end of the plot the necessary space for turning around with tractor (fig. 13).

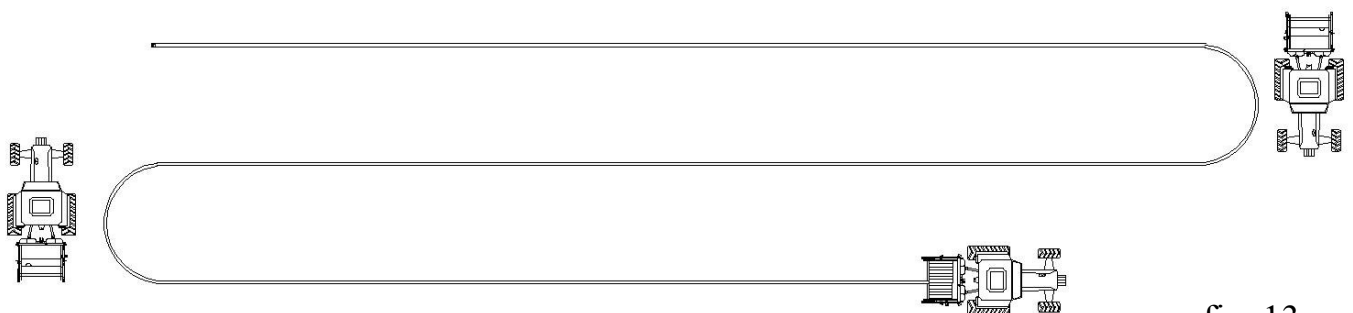

fig. 13

- Stop tractor and reel rotation before releasing the hose end from reeler. Remove manually the hose quick coupling from the opening in the hose drum (fig. 14-15)

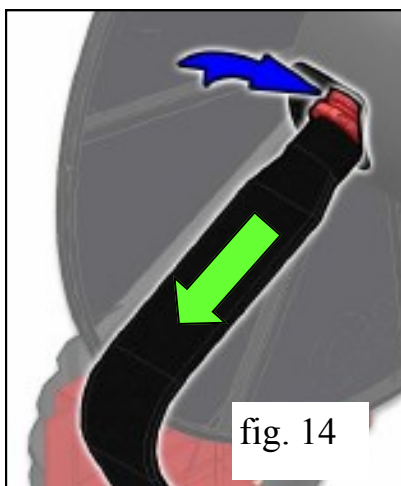

fig. 14

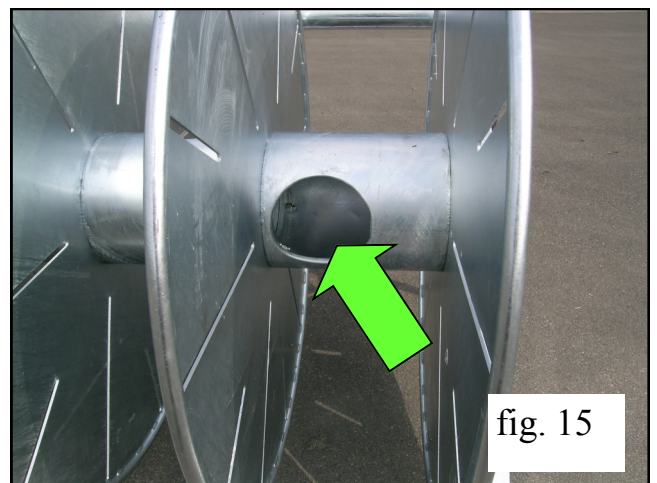
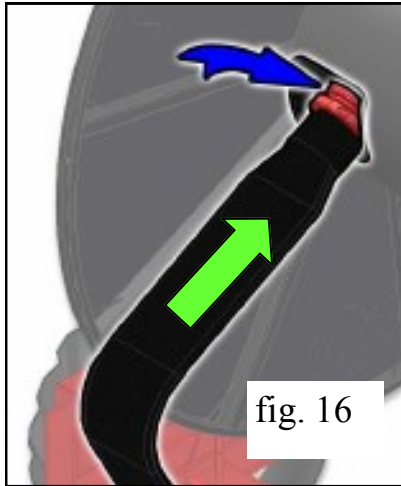
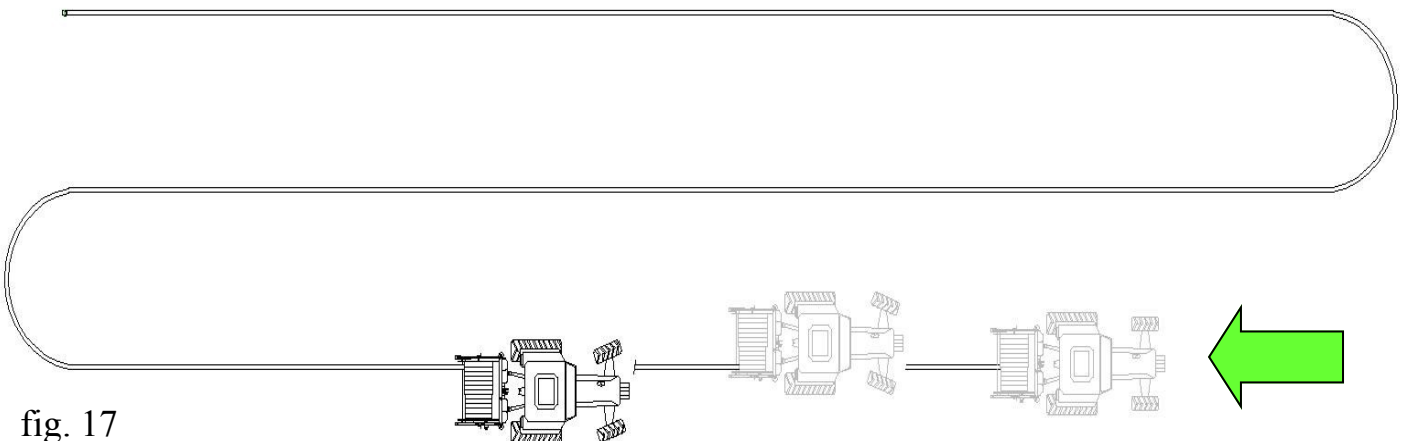

fig. 15

- Position the tractor at the hose end.
- Keep the reeler lifted 30 cm over the ground.
- Join the hose end with the reeler by inserting manually the hose quick coupling in the opening in the hose drum (fig. 15-16).



By the lever, see figure 10, change the reel rotation speed. Drive the tractor back at a suitable speed, by moving in turn on the right and on the left in order to roll the hose uniformly on the reel drum. (fig. 17).



N.B. Before rolling up the hose, we suggest that a washing cycle with water should be executed to prevent any possible organic residues from fermenting and consequently swelling up the flat hose with gas.

If possible, before rolling the hose, set it as straight as possible. (Before removing it from the two ends i.e. when still under pressure, drag it onto the ground, till a line as straight as possible is obtained)

Attention!

The pressure of gases generated by possible organic residues can deform and damage permanently the reeler.

Attention!

Before rolling up the hose, disconnect both its ends so that the liquid on the inside could be discharged.

Attention!

The power supplied by the hydraulic motor is not sufficient to roll up the hose by dragging it, therefore do not force the reel rotation movement if the tractor is standing.

7. OPERATING AND SAFETY RULES

- 1) Both during working phases and inspection ones, wear always proper clothing (overalls, gloves, helmet, accident prevention shoes, fastened clothes, etc...).
- 2) The machine has always to be used in a well-lit place.
- 3) Since gases released by liquid manure are poisonous, check that during maintenance:
 - the work area is suitably ventilated;
 - the machine is not inspected near to flames.
- 4) The machine has to be used only by accountable adults and in a place not be accessible to children.
- 5) Do not carry out operations or adjustments when the machine is in motion or when it is connected to supply.
- 6) Before starting work phases, check that the whole assembly is stable (machine and tractor).
- 7) During maintenance verify that the machine is perfectly steady and safe , i.e. so that it can not endanger the user safety.
- 8) During operation, maintenance or adjustment, the rubber parts of the machine have not to come into contact with oil, grease or oil derivatives.
- 9) Check if the proper fixing joints are in perfect conditions. Do not stop near them because of burst and tearing hazard.
- 11) In case the equipment is not employed for a quite long time, wash it and keep it in a dry place protected against bad weather .
- 12) Lubricate periodically all moving components.

8. MAINTENANCE

Before carrying out any maintenance operation stop the machine and disconnect it from supply.

- 1) Each 15 operating hours lubricate all parts which need it (see page 4).
- 2) At the end of each machine employment wash it in order to prevent slurry from hardening.
- 3) Check periodically if all screws are loosen. If necessary tighten or replace them.
- 4) Check periodically chain tension and wear (fig. 18). If it is necessary to adjust the chain, act as follows: loosen the screws "A", screw or unscrew the adjusting screw according to needs and at the end tighten the screws "A".

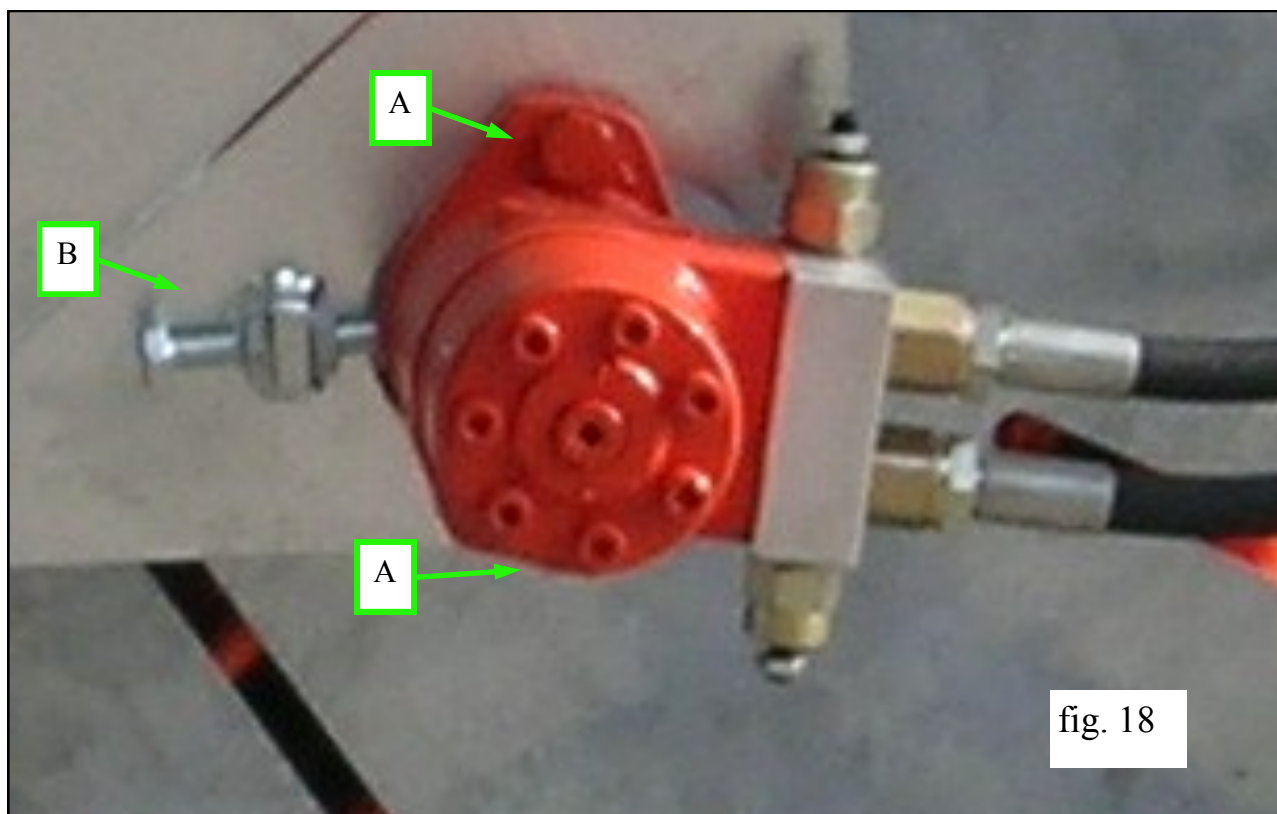
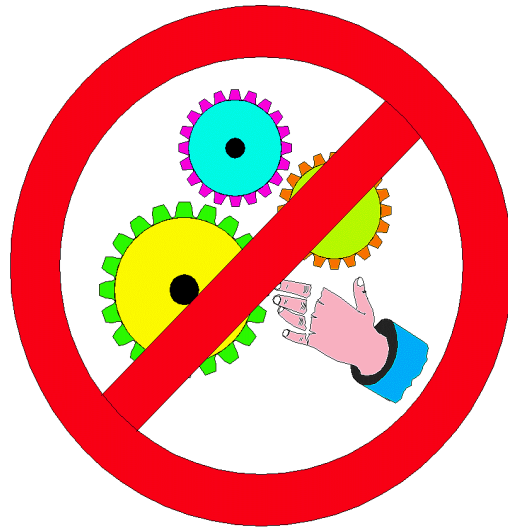
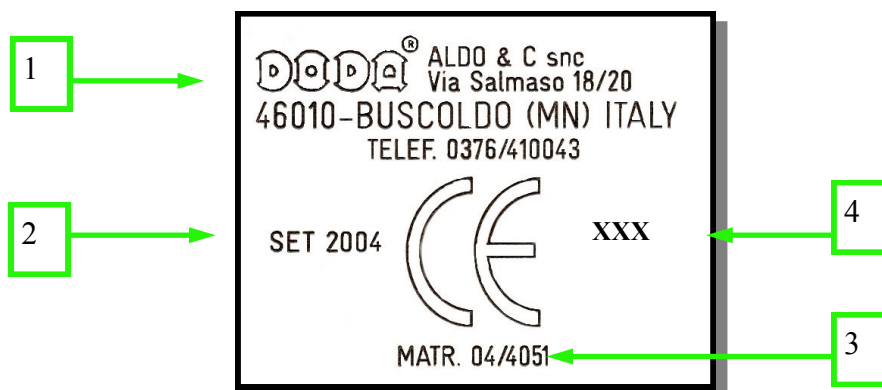

fig. 18

As regards all spare parts, apply directly to DODA authorized dealers.



Do not get near the chain guard during hydraulic motor running



Data plate indicating the conformity with EC regulations:

- 1) **NAME OF THE FIRM**
- 2) **MONTH AND YEAR OF PRODUCTION**
- 3) **SERIAL NUMBER**
- 4) **MACHINE CODE**

- The framework of this equipment is wholly hot galvanized and the reel hubs are in AISI 304 stainless steel.
- Our reel machine is available with single or multi-stage reel, so that hoses with different lengths could be rolled up.
- It is standard provided with a quick coupling/release system for the 3 point lifting device, tanks to which it is possible to replace the reeler without getting off the tractor (fig. 19-20).



fig. 20

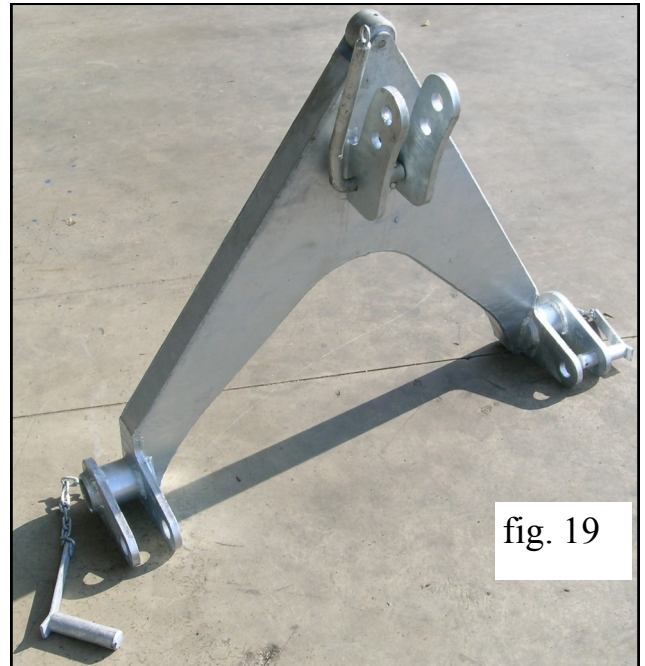

fig. 19

- As optional, an A Frame equipped with a splash plate for slurry spreading can be supplied.(fig.21) This device is coupled up to the tractor with the coupling/release system (fig.22).



fig. 21

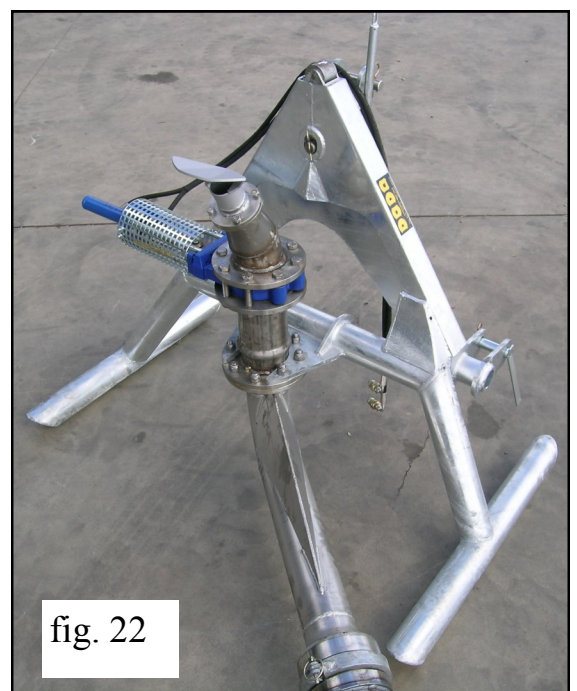
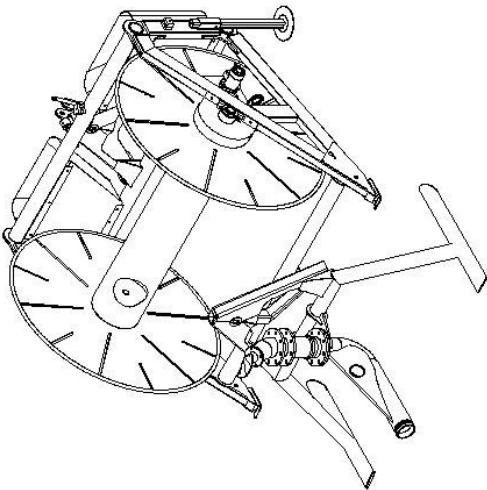
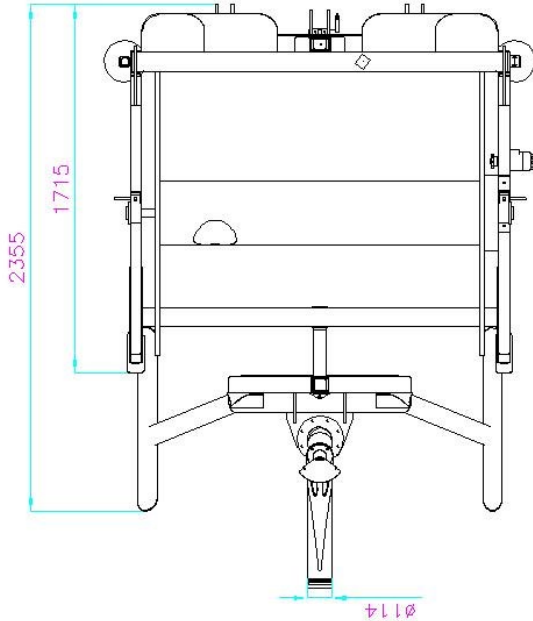
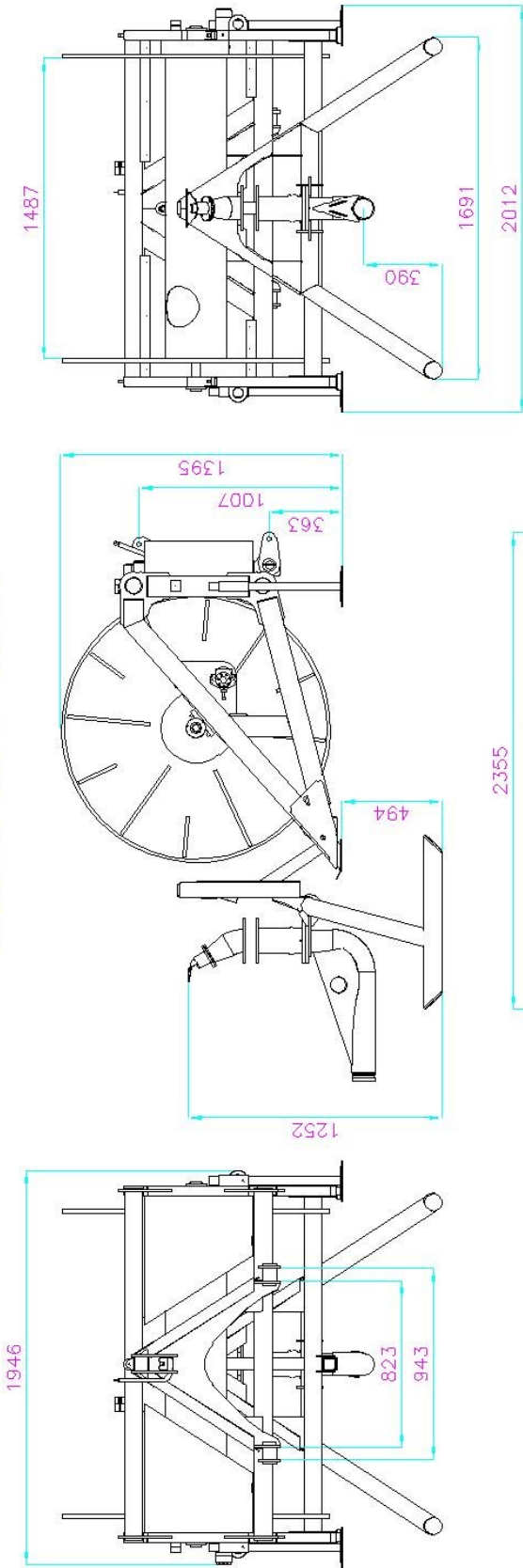

fig. 22



OMBELICO A 1 STADIO



DATA	SCALA	CODICE DISEGNO
26/10/05		IOM1S



OMBELICO A 2 STADI

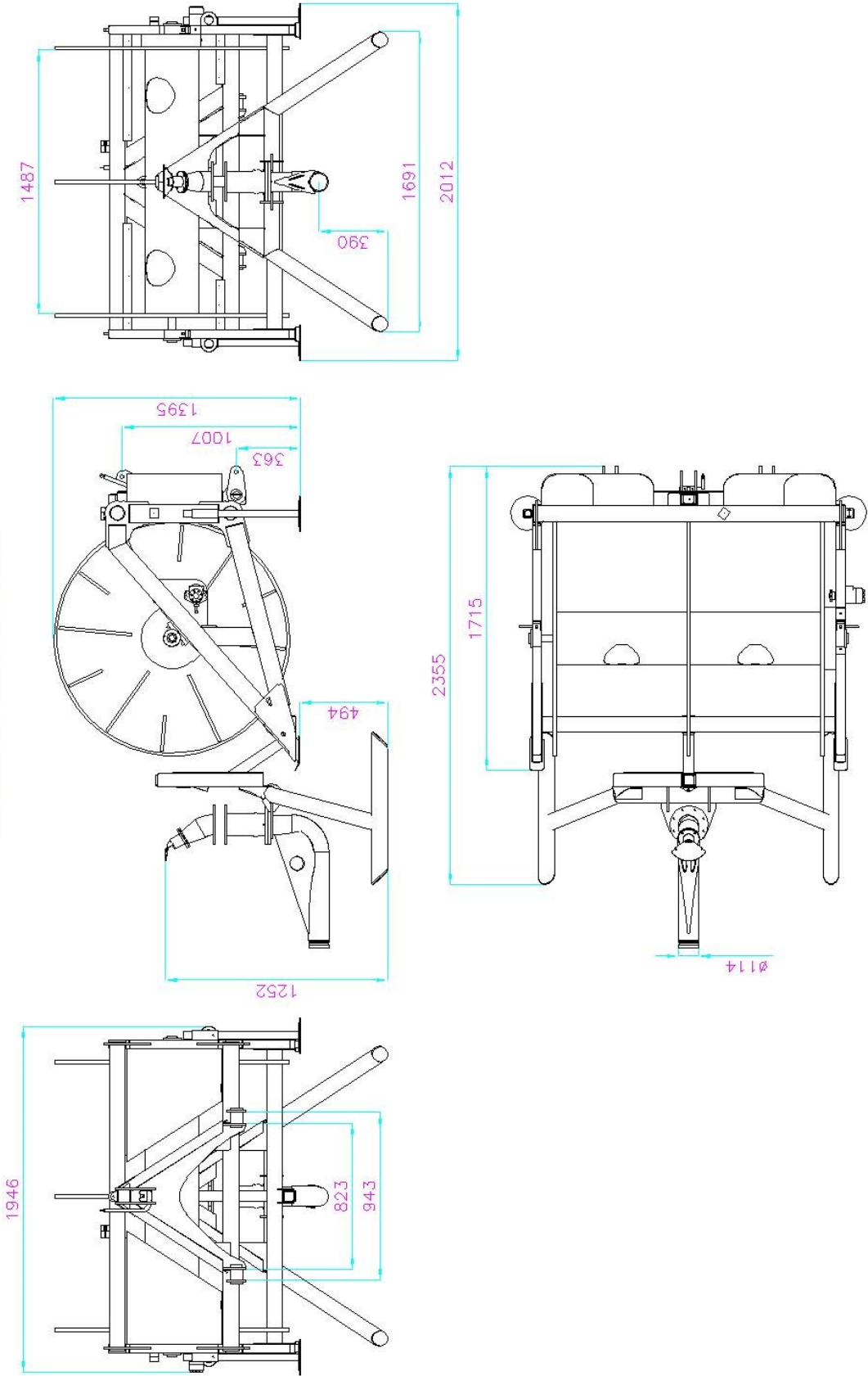

DATA	SCALA	CODICE DISEGNO
05/11/07		10M2S



OMBELICO A 4 STADI

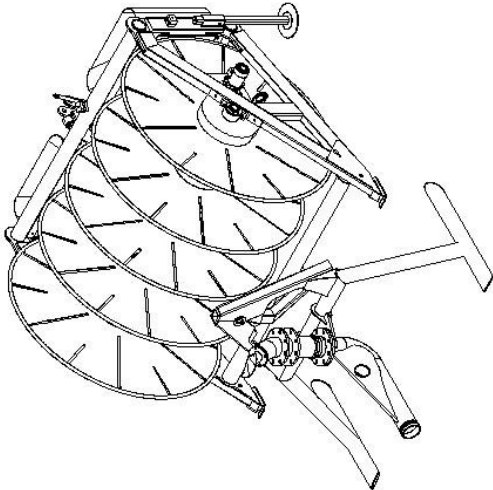
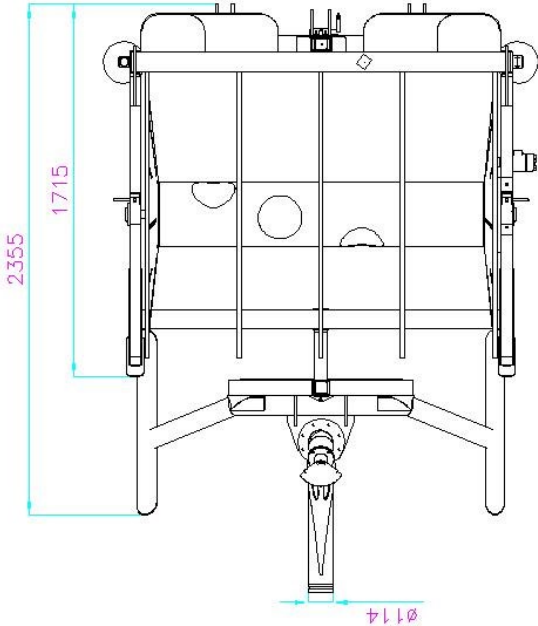
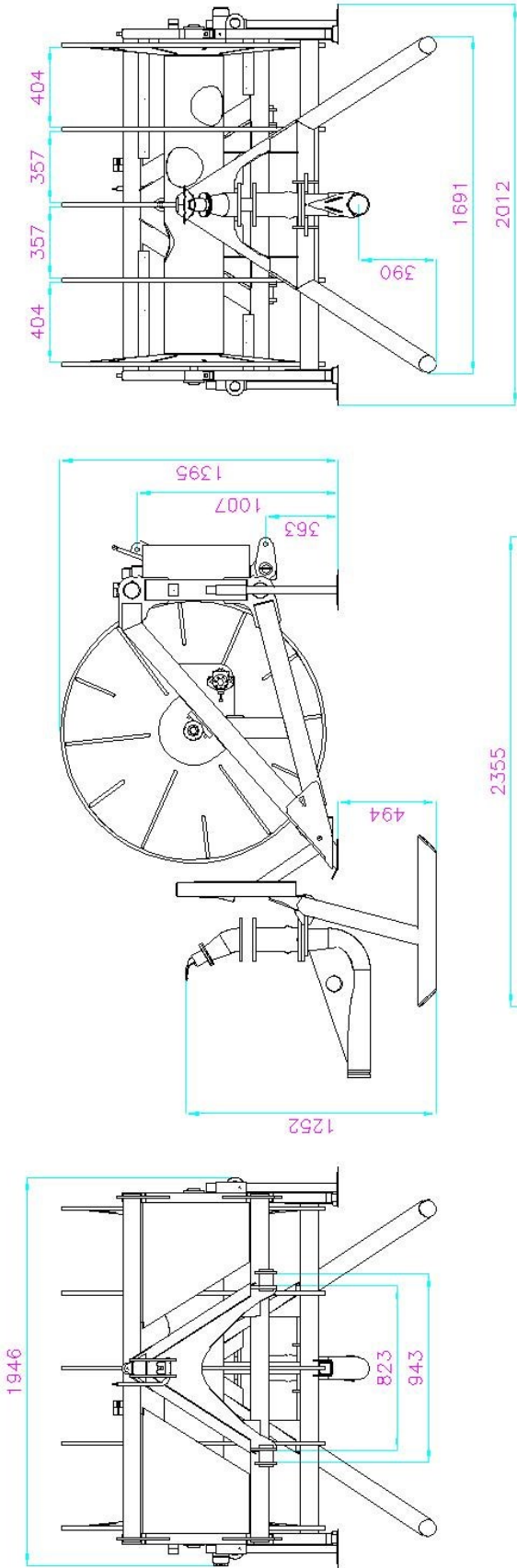

DATA	SCALA	CODICE DISEGNO
25/10/05		IOM4S



OMBELICO A 1 STADIO

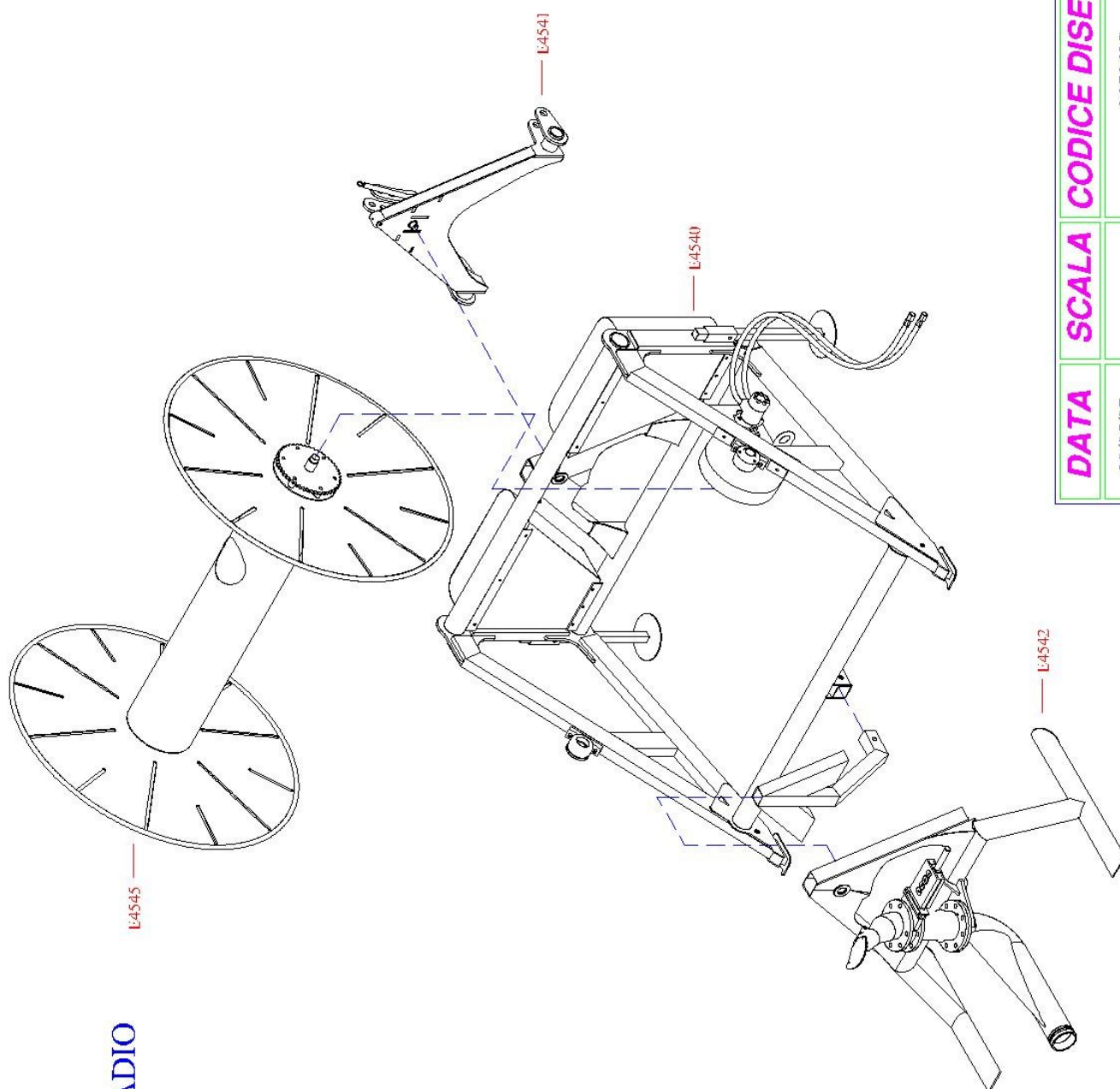

DATA	SCALA	CODICE DISEGNO
30/05/07		MOM1S



OMBELICO A 2 STADI

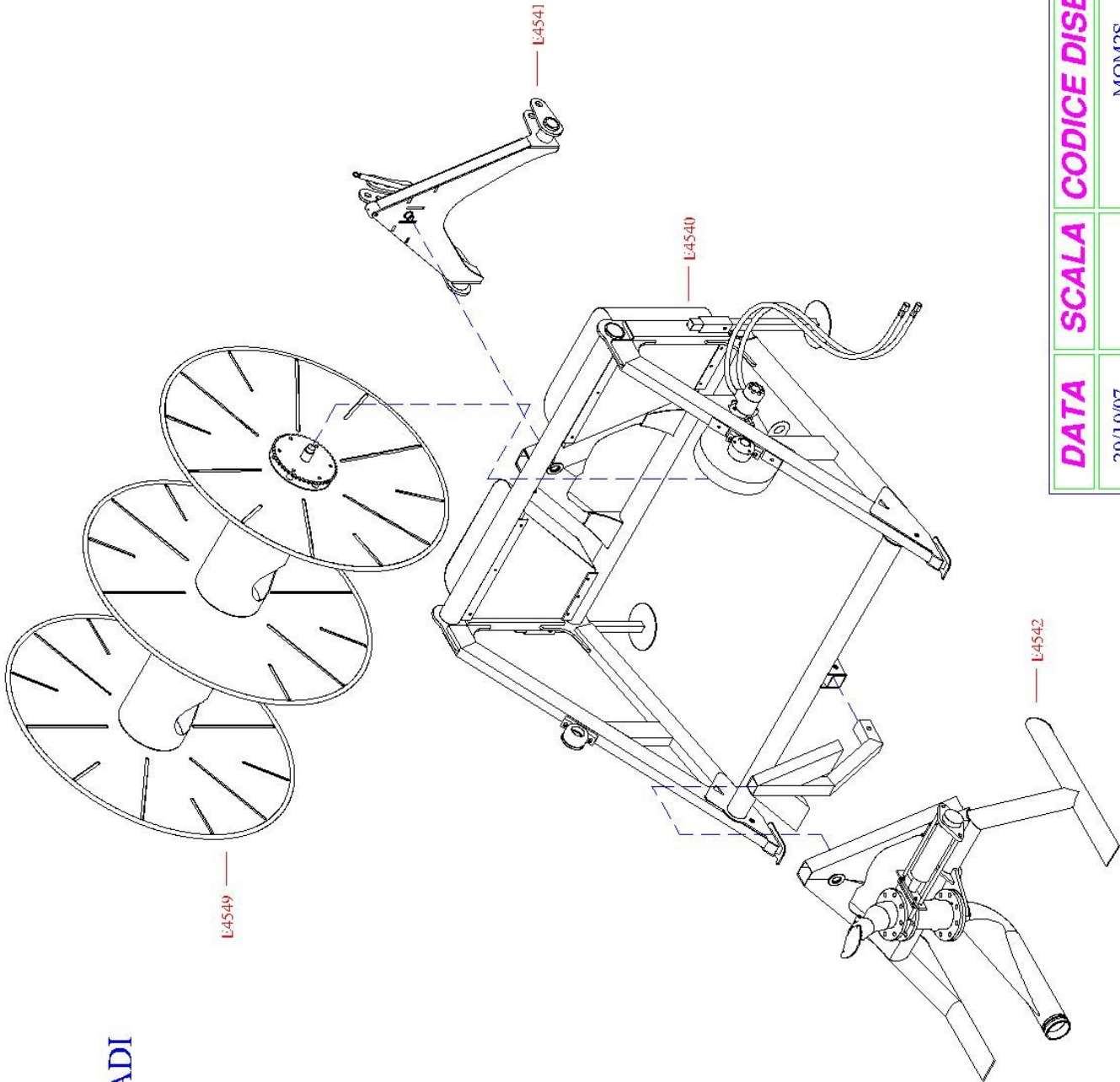

DATA	SCALA	CODICE DISEGNO
29/10/07		MOM2S

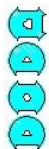

OMBELICO A 4 STADI

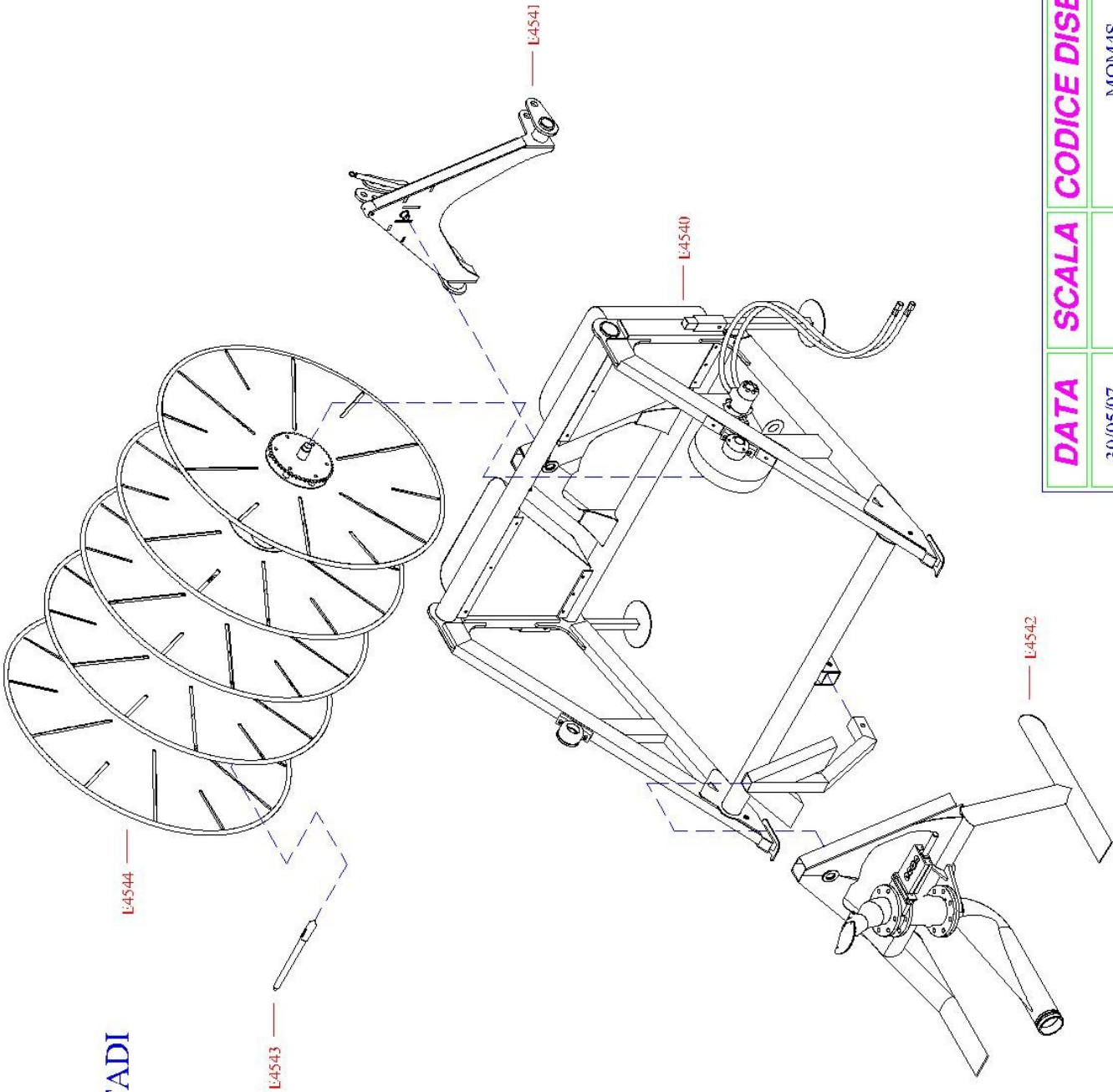

DATA	SCALA	CODICE DISEGNO
30/05/07		MOM4S



AGGANCIO SOLLEVAMENTO

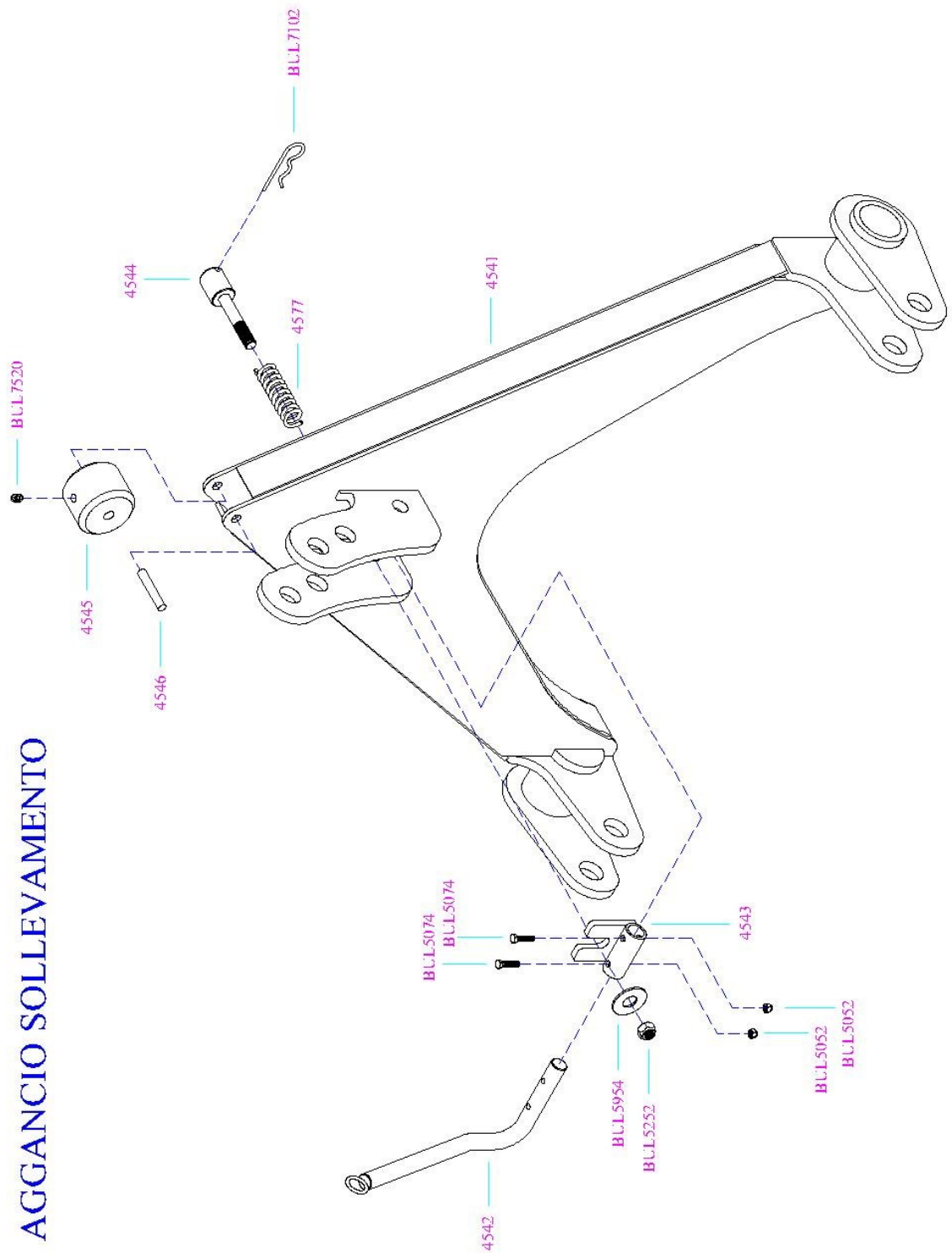

DATA	SCALA	CODICE DISEGNO
20/09/05		E4541



FERMO MANICHETTA

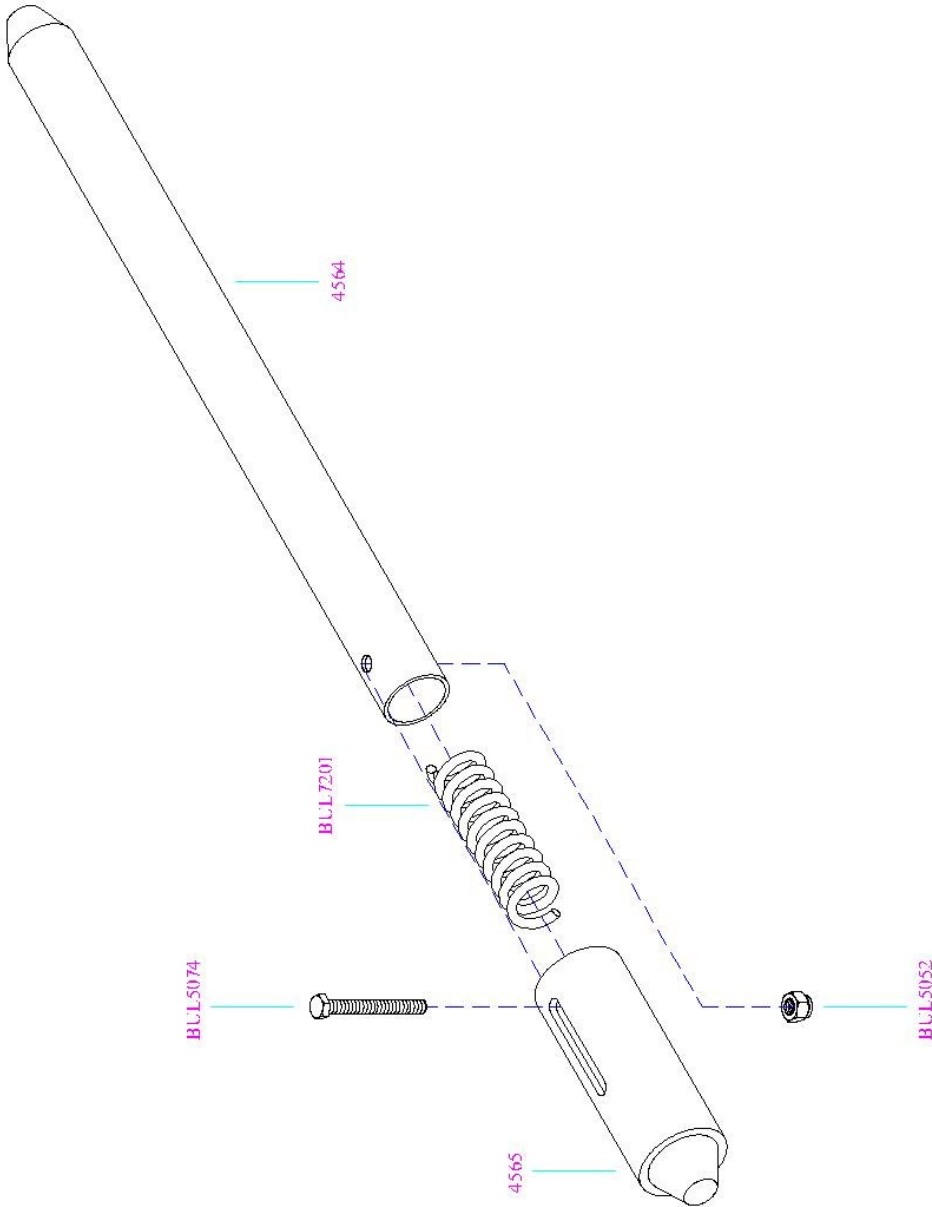

DATA	SCALA	CODICE DISEGNO
22/09/05		E4543

RULLO A 4 SETTORI

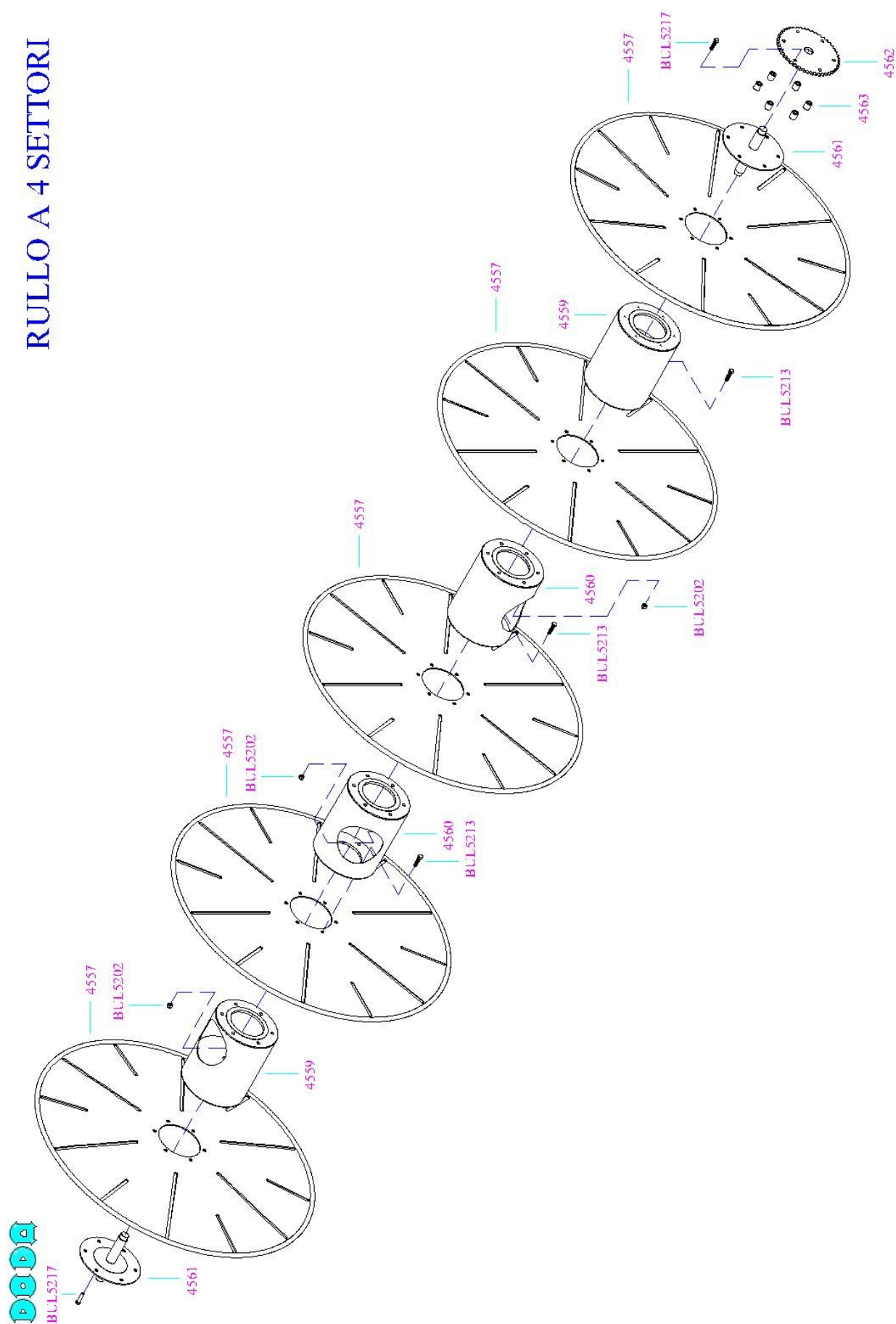

DATA	SCALA	CODICE DISEGNO
20/09/05		E4544



RULLO A 1 SETTORE

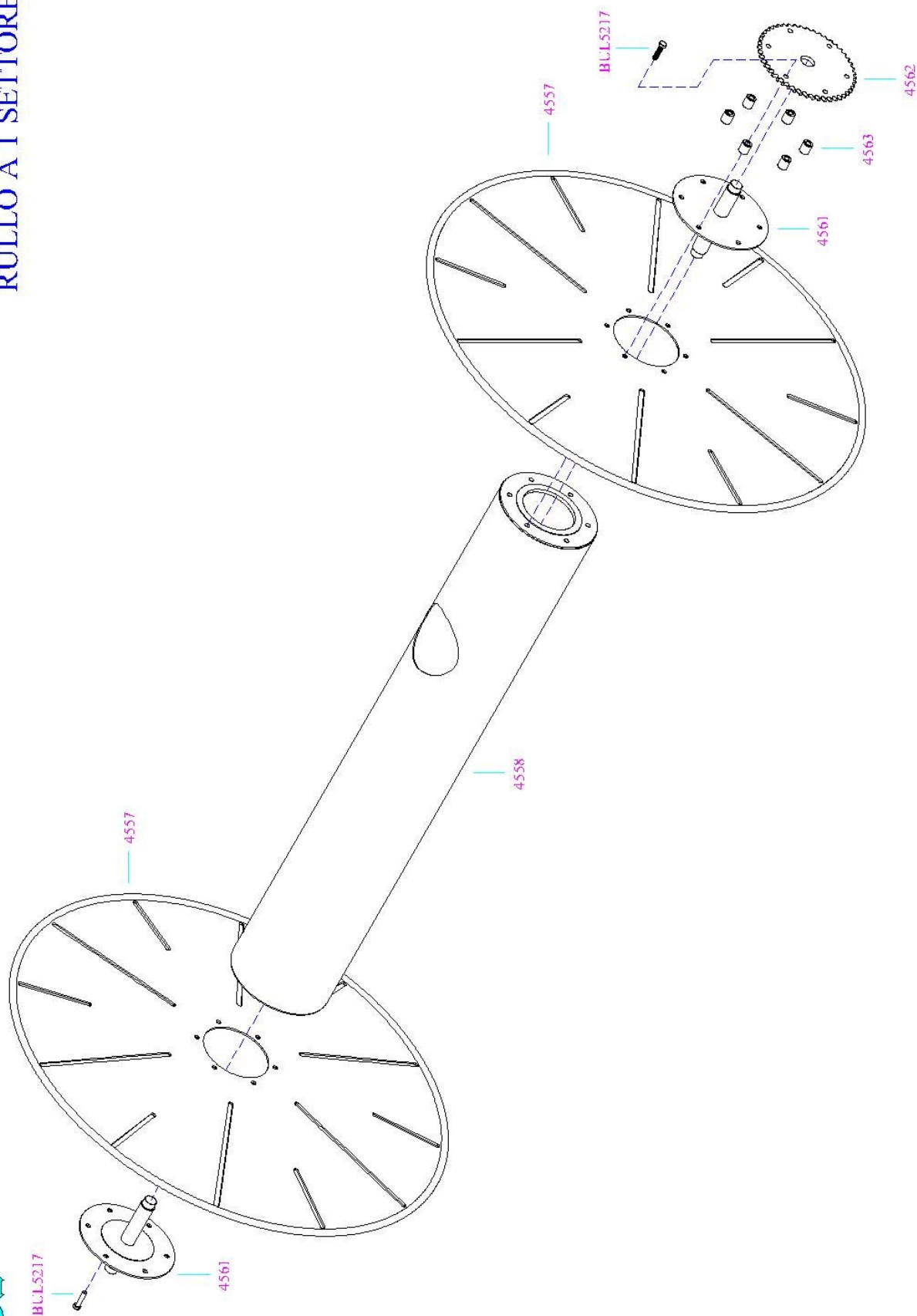

DATA	SCALA	CODICE DISEGNO
20/09/05		E4545

IMPIANTO IDRAULICO SARACINESCA OMBELICO

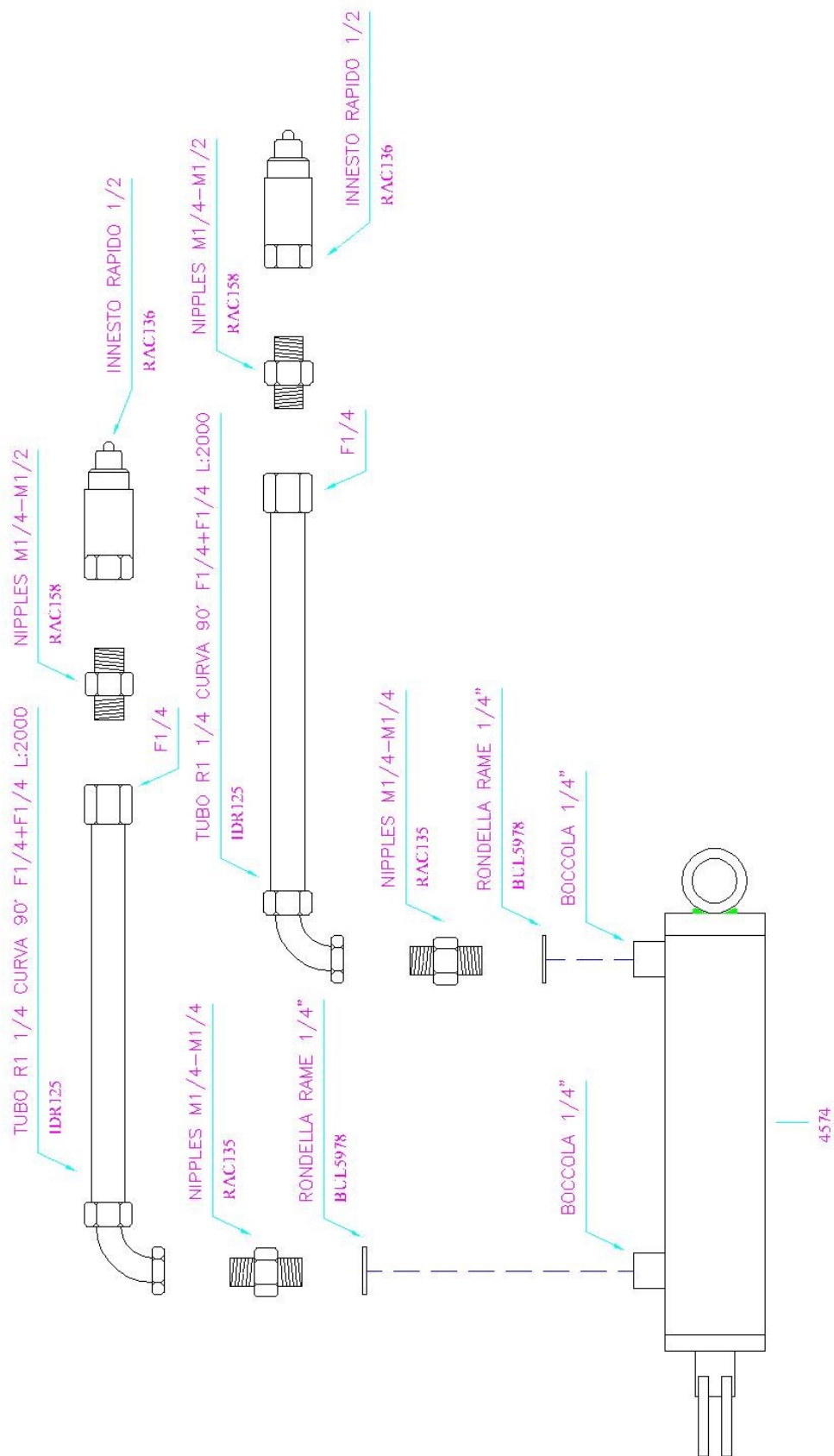

DATA	SCALA	CODICE DISEGNO
21/04/08		E4546



IMPIANTO IDRAULICO MOTORE IDRAULICO OMBELICO

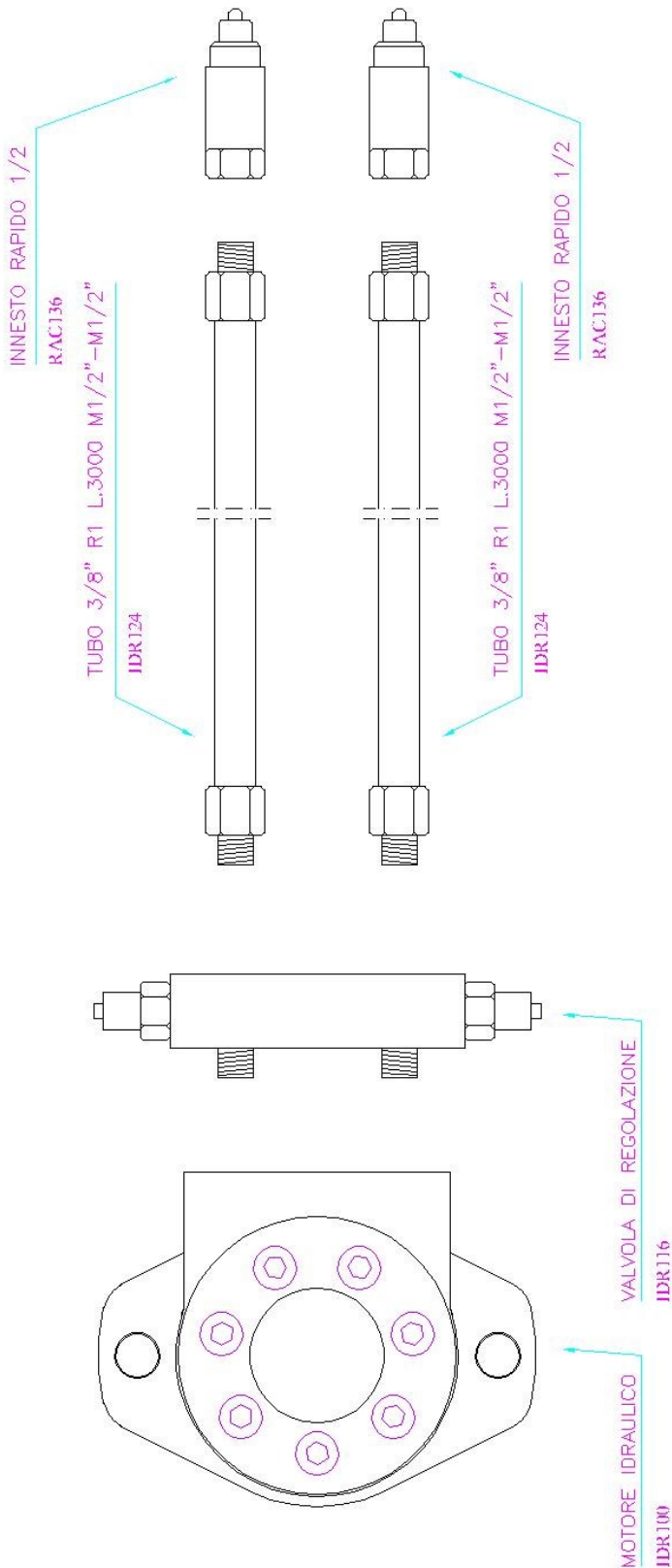

DATA	SCALA	CODICE DISEGNO
24/10/05		E4547



IMPIANTO DI CONTROLLO DELLA PRESSIONE

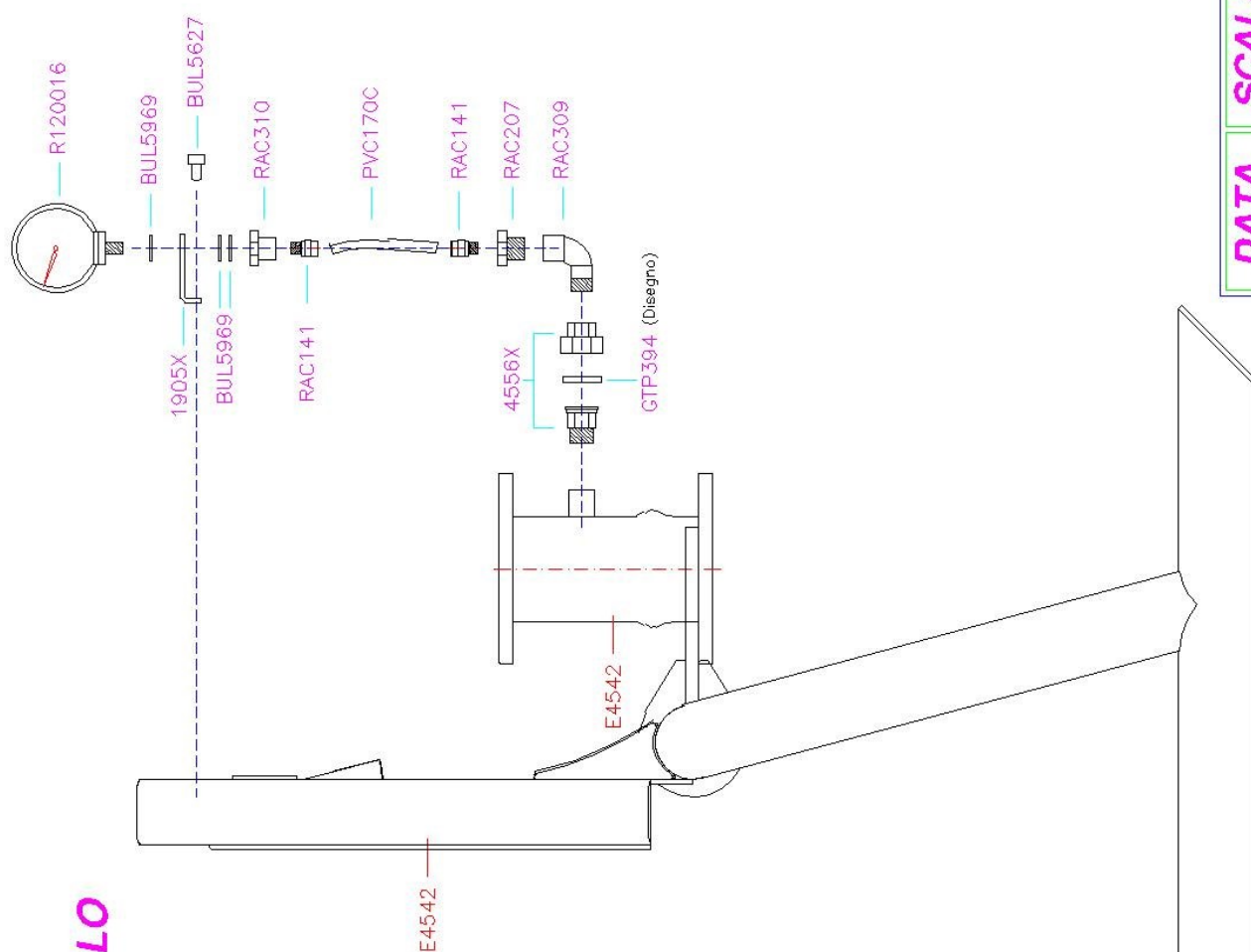

DATA	SCALA	CODICE DISEGNO
17/07/06		E4548



RULLO A 2 SETTORI

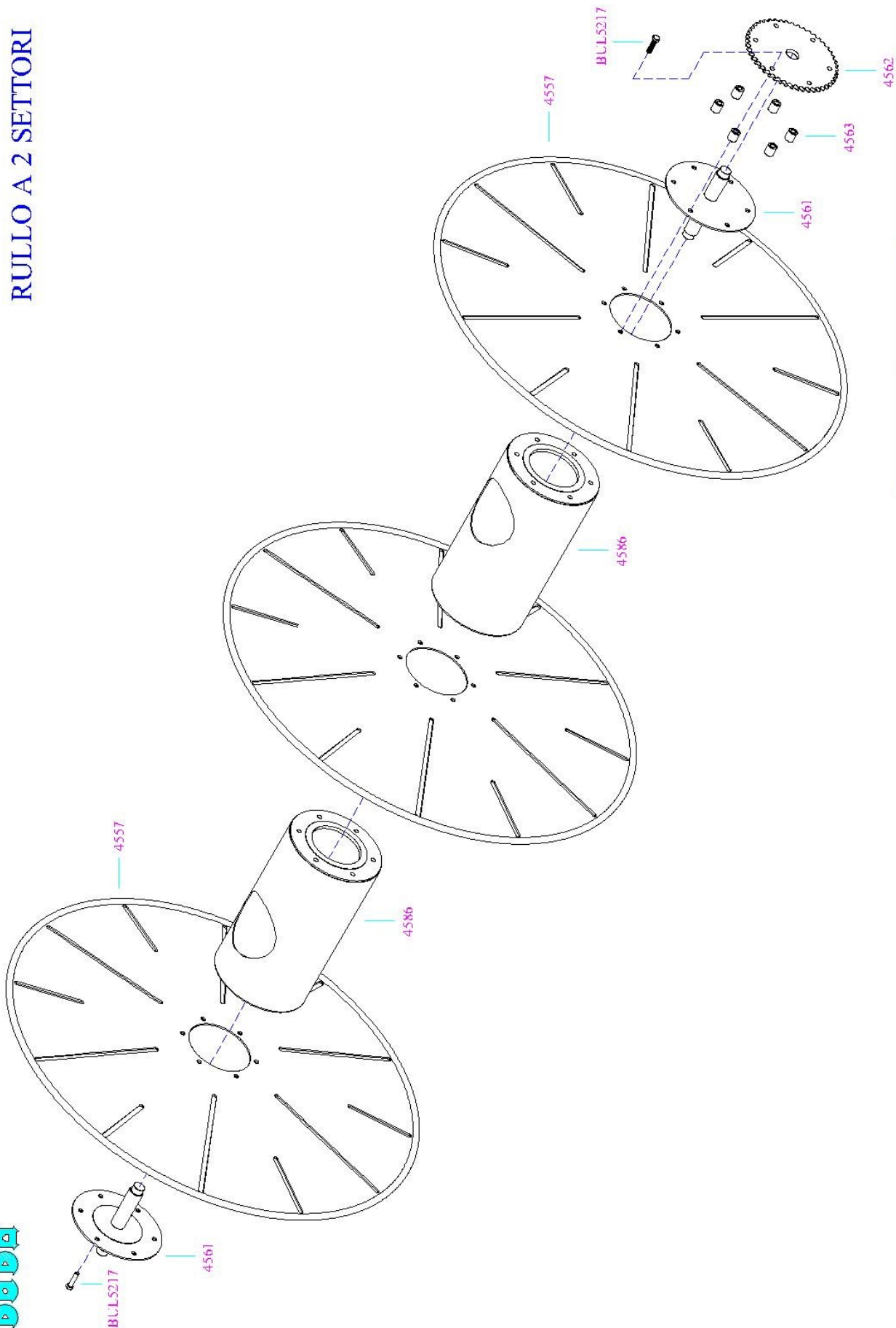

DATA	SCALA	CODICE DISEGNO
05/11/07		E4549

Notes:

Notes:

Notes:

**EC DECLARATION OF CONFORMITY
AS DEFINED BY DIRECTIVE 2006/42/CE AND
FOLLOWING MODIFICATIONS**

WE

DODA ALDO & C. S.N.C.

Via Contrargine Sud, 3/5
46010 Canicossa (Mantova)

HEREBY DECLARE UNDER OUR OWN RESPONSIBILITY THAT THE
FOLLOWING PRODUCT:

HOSE REELER

TO WHICH THIS DECLARATION REFERS, CONFORMS TO DIRECTIVE 2006/42/
CE AND FOLLOWING MODIFICATIONS.

BUSCOLDO (MANTOVA)

.....
(Name, signature, corresponding stamp)



COSTRUZIONE MACCHINE AGRICOLE
di DODA ALDO & C SNC

Via Sante Salmaso 18/20 46010 BUSCOLDO (MN) ITALY

Tel. +39 0376/410043 - Fax. +39 0376/410032

<http://www.doda.com>

Email doda@doda.com
